

3 needle, double chain stitch, feed-off the arm, denim lapseamer

SQ7803PD



3 needle, double chain stitch, feed-off the arm machine, with a differential feeding system and belt puller for extra heavy duty

※Lapseam folder is included



Features

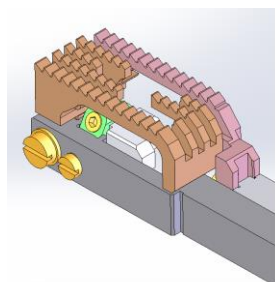

左右差動送り機構

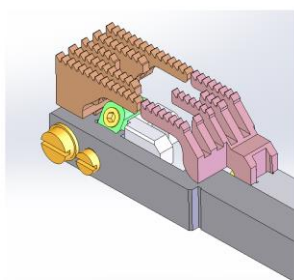

OP 前後差動送り機構



Prevent puckering and sewing slippage

Differential feed mechanism ensures prevents puckering and sewing slippage of the right fabric and left fabric.

Powerful puller for prevention of stitch skipping

The belt type puller provides strong feeding and prevents skip stitch and puckering on the cross joint part of lapseam.

| Model | Application | Material | Needle | No. of Threads | Gauge | Needle bar Stroke | Stitch length stitch/inch | Differential Feed ratio | Presser Foot lift | Maximum Speed |
|----------|-------------|----------|--------------|----------------|-------|-------------------|---------------------------|-------------------------|-------------------|---------------|
| | | | | | | | | | | |
| SQ7803PD | Lap seam | Heavy | UY128GAS #21 | 6 | 1/4 | 33.3mm | 1.4~4.2mm | 0.7-1.3 | 10mm | 5000 |